

**FAG****KM20**

Locknut

Locknuts KM, main dimensions to DIN 981

## Technical information

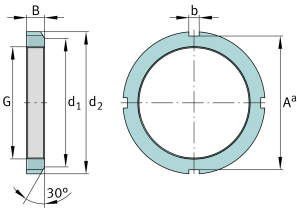

### Main Dimensions & Performance Data

G	M100x2	Thread
d <sub>2</sub>	130 mm	Outerside diameter
B	18 mm	Width
≈m	0.76 kg	Weight

### Mounting dimensions

d <sub>1</sub>	120 mm	Chamfer diameter
b	10 mm	Width retaining slot
A <sup>a</sup>	122 mm	Groove base distance

### Additional information

F	290,000 N	Axial load capacity, static
	MB20	Fuse
	30 °	Chamfer angle