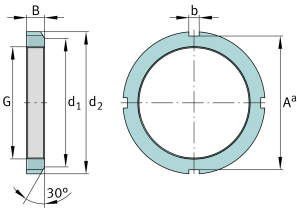

**FAG****KM19**

Locknut

Locknuts KM, main dimensions to DIN 981

Technical information

**Main Dimensions & Performance Data**

G	M95x2	Thread
d ₂	125 mm	Outerside diameter
B	17 mm	Width
≈m	0.673 kg	Weight

Mounting dimensions

d ₁	113 mm	Chamfer diameter
b	10 mm	Width retaining slot
A ^a	117 mm	Groove base distance

Additional information

F	270,000 N	Axial load capacity, static
	MB19	Fuse
	30 °	Chamfer angle