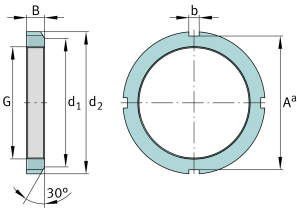

**FAG****KM13**

Locknut

Locknuts KM, main dimensions to DIN 981

Technical information

**Main Dimensions & Performance Data**

G	M65x2	Thread
d ₂	85 mm	Outerside diameter
B	12 mm	Width
≈m	227 g	Weight

Mounting dimensions

d ₁	79 mm	Chamfer diameter
b	7 mm	Width retaining slot
A ^a	79 mm	Groove base distance

Additional information

F	108,000 N	Axial load capacity, static
	MB13	Fuse
	30 °	Chamfer angle