

**FAG****KM11**

Locknut

Locknuts KM, main dimensions to DIN 981

Technical information

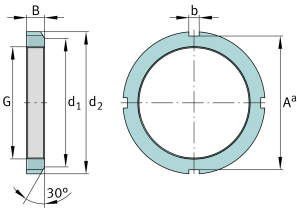

Main Dimensions & Performance Data

G	M55x2	Thread
d ₂	75 mm	Outerside diameter
B	11 mm	Width
≈m	176 g	Weight

Mounting dimensions

d ₁	67 mm	Chamfer diameter
b	7 mm	Width retaining slot
A ^a	69 mm	Groove base distance

Additional information

F	87,000 N	Axial load capacity, static
	MB11	Fuse
	30 °	Chamfer angle