

**FAG****HM52T**

Locknut

Locknut HM

## Technical information

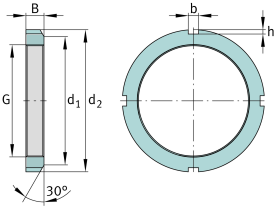

### Main Dimensions & Performance Data

G	Tr260X4	Thread
d <sub>2</sub>	330 mm	Outerside diameter
B	35 mm	Width
≈m	8.433 kg	Weight

### Mounting dimensions

d <sub>1</sub>	300 mm	Chamfer diameter
b	24 mm	Width retaining slot
h	12 mm	Height retaining slot

### Additional information

F	2,700,000 N	Axial load capacity, static
	MB52	Fuse
	30 °	Chamfer angle