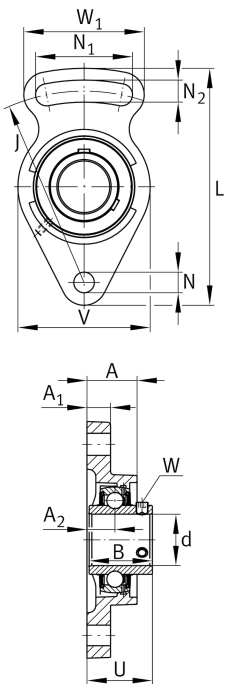

**FAG****UCFA211** [↗](#)

Take-up housing unit

Housing units UCFA, cast iron housing, radial insert ball bearing with grub screws in inner ring, RSR seals, for swivel motion

Technical information

**Your current product variant**

Material	GG	Grey cast iron
----------	----	----------------

Main Dimensions & Performance Data

d	55 mm	Bore diameter
L	219 mm	Length total
U	58.4 mm	Total height unit
≈m	2.96 kg	Weight

Mounting dimensions

N	16 mm	Fixing bore
N ₁	86 mm	Length (slot)
N ₂	16 mm	Width (slot)
J	184 mm	Distance fixing bore

Dimensions

A ₁	20 mm	Thickness of flange
A ₂	25 mm	Distance raceway
A	43 mm	Height housing
V	130 mm	Shoulder diameter housing
W	104 mm	Width housing slot side
Q	M6	Connection thread for lubrication



Additional information

FA211	Housing
UC211	Bearing designation

Temperature range

T _{min}	-20 °C	Operating temperature min.
T _{max}	120 °C	Operating temperature max.