

**FAG****UCFA210** [↗](#)

Take-up housing unit

Housing units UCFA, cast iron housing, radial insert ball bearing with grub screws in inner ring, RSR seals, for swivel motion

Technical information

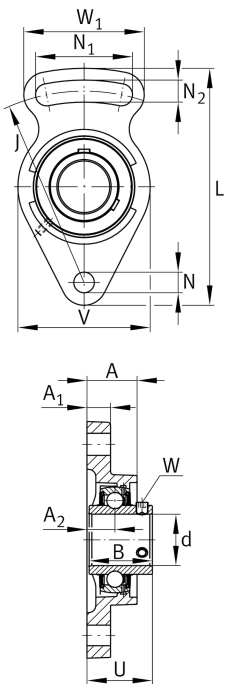

Your current product variant

Material	GG	Grey cast iron
----------	----	----------------

Main Dimensions & Performance Data

d	50 mm	Bore diameter
L	190 mm	Length total
U	54.6 mm	Total height unit
≈m	2.09 kg	Weight

Mounting dimensions

N	16 mm	Fixing bore
N ₁	76 mm	Length (slot)
N ₂	16 mm	Width (slot)
J	157 mm	Distance fixing bore

Dimensions

A ₁	18 mm	Thickness of flange
A ₂	22 mm	Distance raceway
A	37.5 mm	Height housing
V	115 mm	Shoulder diameter housing
W	94 mm	Width housing slot side
Q	M6	Connection thread for lubrication



Additional information

FA210	Housing
UC210	Bearing designation

Temperature range

T _{min}	-20 °C	Operating temperature min.
T _{max}	120 °C	Operating temperature max.