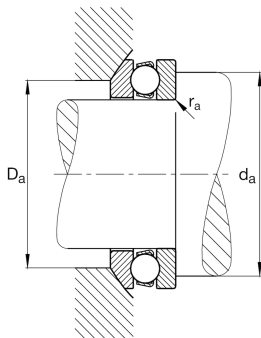

**FAG****53213** **Axial deep groove ball bearing**

Axial deep groove ball bearing 532, single direction, with spherical housing washer, steel sheet metal cage

Technical information

**Your current product variant**

Cage	JP	Steel sheet metal
Tolerance class	PN	Normal (ISO 492:2023)
Dimensional / heat stabilization	S0	Rings dimensional stabilized up to 150°

Main Dimensions & Performance Data

d	65 mm	Inner diameter shaft washer
D	100 mm	Outer diameter housing washer
T	28.7 mm	Height
C _a	64,000 N	Basic dynamic load rating, axial
C _{0a}	149,000 N	Basic static load rating, axial
C _{ua}	6,800 N	Fatigue load limit, axial
n _G	4,100 1/min	Limiting speed
n _{gr}	4,900 1/min	Reference speed
≈m	0.727 kg	Weight

Mounting dimensions

d _{a min}	86 mm	Minimum diameter shaft shoulder
D _{a max}	82 mm	Maximum diameter of housing shoulder
r _{a max}	1 mm	Maximum filled radius



Dimensions

r_{\min}	1 mm	Minimum chamfer dimension
D_1	67 mm	Inner diameter housing washer
d_1	100 mm	Outer diameter shaft washer
R	80 mm	Radius spherical housing washer
A	40 mm	Distance of the center point
T_1	32 mm	Height with seat washer
D_2	82 mm	Bore diameter seat washer
D_3	105 mm	Outside diameter seat washer
C	9 mm	Height seat washer

Temperature range

T_{\min}	-30 °C	Operating temperature min.
T_{\max}	150 °C	Operating temperature max.

Calculation factors

A	0.14	Minimum load factor
---	------	---------------------

Additional information

U213	Seat washer
------	-------------

Characteristics

F_a	Axial load in one direction
	Grease Lubrication
	Oil Lubrication
	Not sealed
	Static angular error and misalignment