

**FAG****53208**

Axial deep groove ball bearing

Axial deep groove ball bearing 532, single direction, with spherical housing washer, steel sheet metal cage

Technical information

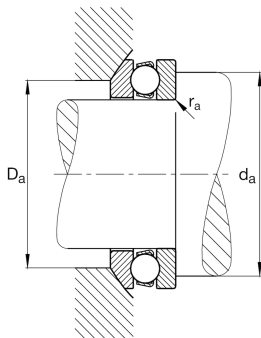

Your current product variant

Cage	JP	Steel sheet metal
Tolerance class	PN	Normal (ISO 492:2023)
Dimensional / heat stabilization	S0	Rings dimensional stabilized up to 150°

Main Dimensions & Performance Data

d	40 mm	Inner diameter shaft washer
D	68 mm	Outer diameter housing washer
T	20.3 mm	Height
C_a	44,000 N	Basic dynamic load rating, axial
C_{0a}	97,000 N	Basic static load rating, axial
C_{ua}	4,400 N	Fatigue load limit, axial
n_G	5,500 1/min	Limiting speed
n_{gr}	6,900 1/min	Reference speed
$\approx m$	0.28 kg	Weight

Mounting dimensions

$d_{a \min}$	57 mm	Minimum diameter shaft shoulder
$D_{a \max}$	55 mm	Maximum diameter of housing shoulder
$r_{a \max}$	1 mm	Maximum filled radius



Dimensions

r_{\min}	1 mm	Minimum chamfer dimension
D_1	42 mm	Inner diameter housing washer
d_1	68 mm	Outer diameter shaft washer
R	56 mm	Radius spherical housing washer
A	28.5 mm	Distance of the center point
T_1	23 mm	Height with seat washer
D_2	55 mm	Bore diameter seat washer
D_3	72 mm	Outside diameter seat washer
C	7 mm	Height seat washer

Temperature range

T_{\min}	-30 °C	Operating temperature min.
T_{\max}	150 °C	Operating temperature max.

Calculation factors

A	0.05	Minimum load factor
---	------	---------------------

Additional information

U208	Seat washer
------	-------------

Characteristics

F_a	Axial load in one direction
	Grease Lubrication
	Oil Lubrication
	Not sealed
	Static angular error and misalignment