

**FAG****51324-MP**

Axial deep groove ball bearing

Axial deep groove ball bearing 513...MP,
single direction, solid brass cage

Technical information

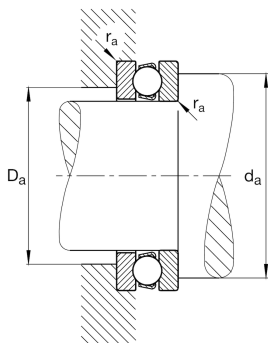

Your current product variant

| | | |
|----------------------------------|----|------------------------------------------|
| Cage | MP | Solid brass cage, rolling element guided |
| Tolerance class | PN | Normal (ISO 492:2023) |
| Dimensional / heat stabilization | S0 | Rings dimensional stabilized up to 150° |

Main Dimensions & Performance Data

| | | |
|-----------------|-------------|----------------------------------|
| d | 120 mm | Inner diameter shaft washer |
| D | 210 mm | Outer diameter housing washer |
| T | 70 mm | Height |
| C _a | 325,000 N | Basic dynamic load rating, axial |
| C _{0a} | 910,000 N | Basic static load rating, axial |
| C _{ua} | 32,500 N | Fatigue load limit, axial |
| n _G | 1,610 1/min | Limiting speed |
| n _{gr} | 3,200 1/min | Reference speed |
| m | 10.414 kg | Weight |

Mounting dimensions

| | | |
|--------------------|--------|--------------------------------------|
| d _{a min} | 174 mm | Minimum diameter shaft shoulder |
| D _{a max} | 156 mm | Maximum diameter of housing shoulder |
| r _{a max} | 2.1 mm | Maximum filled radius |



Dimensions

| | | |
|------------|--------|-------------------------------|
| r_{\min} | 2.1 mm | Minimum chamfer dimension |
| D_1 | 123 mm | Inner diameter housing washer |
| d_1 | 205 mm | Outer diameter shaft washer |

Temperature range

| | | |
|------------|--------|----------------------------|
| T_{\min} | -30 °C | Operating temperature min. |
| T_{\max} | 150 °C | Operating temperature max. |

Calculation factors

| | | |
|---|-----|---------------------|
| A | 4.4 | Minimum load factor |
|---|-----|---------------------|

Characteristics

-  Axial load in one direction
-  Grease Lubrication
-  Oil Lubrication
-  Not sealed