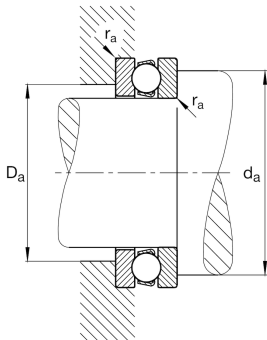

**FAG****51134-MP**

Axial deep groove ball bearing

Axial deep groove ball bearing 511..-MP,  
single direction, solid brass cage

## Technical information

**Your current product variant**

Cage	MP	Solid brass cage, rolling element guided
Tolerance class	PN	Normal (ISO 492:2023)
Dimensional / heat stabilization	S0	Rings dimensional stabilized up to 150°

**Main Dimensions & Performance Data**

d	170 mm	Inner diameter shaft washer
D	215 mm	Outer diameter housing washer
T	34 mm	Height
C <sub>a</sub>	127,000 N	Basic dynamic load rating, axial
C <sub>0a</sub>	510,000 N	Basic static load rating, axial
C <sub>ua</sub>	16,700 N	Fatigue load limit, axial
n <sub>G</sub>	2,330 1/min	Limiting speed
n <sub>gr</sub>	2,010 1/min	Reference speed
m	2,978 kg	Weight

**Mounting dimensions**

d <sub>a min</sub>	197 mm	Minimum diameter shaft shoulder
D <sub>a max</sub>	188 mm	Maximum diameter of housing shoulder
r <sub>a max</sub>	1 mm	Maximum fillet radius



### Dimensions

$r_{\min}$	1.1 mm	Minimum chamfer dimension
$D_1$	172 mm	Inner diameter housing washer
$d_1$	213 mm	Outer diameter shaft washer

### Temperature range

$T_{\min}$	-30 °C	Operating temperature min.
$T_{\max}$	150 °C	Operating temperature max.

### Calculation factors

A	1.4	Minimum load factor
---	-----	---------------------

### Characteristics

-  Axial load in one direction
-  Grease Lubrication
-  Oil Lubrication
-  Not sealed