

**FAG****51104**

Axial deep groove ball bearing

Axial deep groove ball bearing 511, single direction, steel sheet metal cage

Technical information

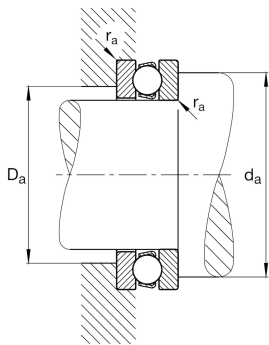
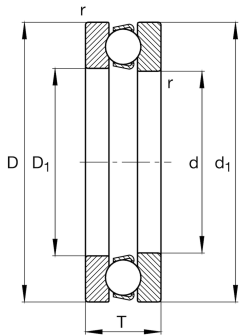

Your current product variant

Cage	JP	Steel sheet metal
Tolerance class	PN	Normal (ISO 492:2023)
Dimensional / heat stabilization	S0	Rings dimensional stabilized up to 150°

Main Dimensions & Performance Data

d	20 mm	Inner diameter shaft washer
D	35 mm	Outer diameter housing washer
T	10 mm	Height
C_a	15,000 N	Basic dynamic load rating, axial
C_{0a}	26,500 N	Basic static load rating, axial
C_{ua}	1,210 N	Fatigue load limit, axial
n_G	10,900 1/min	Limiting speed
n_{gr}	11,100 1/min	Reference speed
$\approx m$	40 g	Weight

Mounting dimensions

$d_{a \min}$	29 mm	Minimum diameter shaft shoulder
$D_{a \max}$	26 mm	Maximum diameter of housing shoulder
$r_{a \max}$	0.3 mm	Maximum fillet radius



Dimensions

r_{\min}	0.3 mm	Minimum chamfer dimension
D_1	21 mm	Inner diameter housing washer
d_1	35 mm	Outer diameter shaft washer





Temperature range

T_{\min}	-30 °C	Operating temperature min.
T_{\max}	150 °C	Operating temperature max.

Calculation factors

A	0.004	Minimum load factor
---	-------	---------------------

Characteristics

-  Axial load in one direction
-  Grease Lubrication
-  Oil Lubrication
-  Not sealed