

**FAG****4307-BB-TVH** [↗](#)

## Deep groove ball bearing

Deep groove ball bearing 43...BB-TVH,  
double row, plastic cage

## Technical information

## Your current product variant

Design variant	B	Bearing without filling slot
Tolerance class	PN	Normal (ISO 492:2023)
Changed internal design	B	B
Cage	TVH	Solid cage made of glass-fiber reinforced polyamid PA66
Lubricant	GA13	Ball bearing and insert bearing grease
Dimensional / heat stabilization	SN	Rings dimensional stabilized up to 120°
Radial internal clearance	CN (Group N)	Normal internal clearance

## Main Dimensions &amp; Performance Data

d	35 mm	Bore diameter
D	80 mm	Outside diameter
B	31 mm	Width
$C_r$	58,000 N	Basic dynamic load rating, radial
$C_{0r}$	40,500 N	Basic static load rating, radial
$C_{ur}$	2,120 N	Fatigue load limit, radial
$n_G$	8,100 1/min	Limiting speed
$n_{gr}$	6,900 1/min	Reference speed
$\approx m$	0.651 kg	Weight

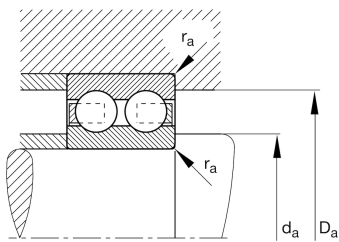
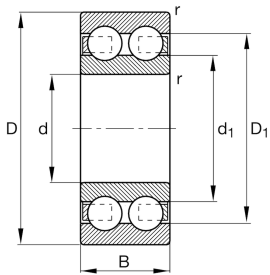



### Mounting dimensions

$d_{a \min}$	44 mm	Minimum diameter shaft shoulder
$D_{a \max}$	71 mm	Maximum diameter of housing shoulder
$r_{a \max}$	1.5 mm	Maximum fillet radius

### Dimensions

$r_{\min}$	1.5 mm	Minimum chamfer dimension
$D_1$	68.15 mm	Shoulder diameter outer ring
$d_1$	48.2 mm	Shoulder diameter inner ring

### Temperature range

$T_{\min}$	-20 °C	Operating temperature min.
$T_{\max}$	120 °C	Operating temperature max.

### Calculation factors

$f_0$	12.9	Calculation factor
-------	------	--------------------

### Characteristics



Radial load



Axial load in one direction



Axial load in two directions



Grease Lubrication



Not sealed